



## 42a Hestercombe Avenue Fulham, SW6

Exquisitely designed, constructed and finished by Baynham Couldridge, one of the country's leading luxury development teams

A stunning newly refurbished upper maisonette set just off the Munster Road; 42a Hestercombe Avenue is a testament to the wonders that can be achieved from humble beginnings.

Behind the faithfully restored Victorian exterior, the property offers nearly 1000 square feet of living space within which high-end technology has been perfectly integrated to create a sublime, modern living space of the utmost simplicity and convenience.

Finished to the highest standards, 42a Hestercombe Avenue instantly creates a home lifestyle to rival that of the best apartments in London and beyond. From the completely reconstructed shell to the finest bespoke details, this development captivates and enthrals on every level.

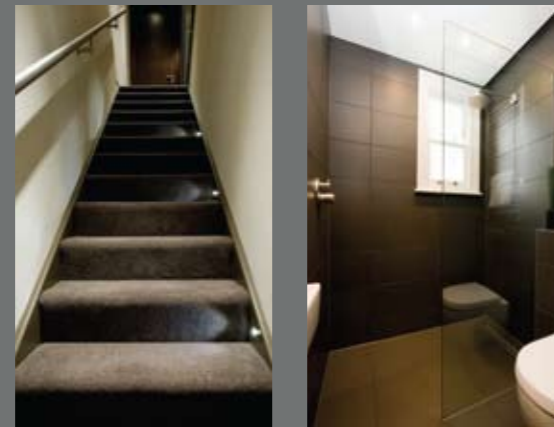

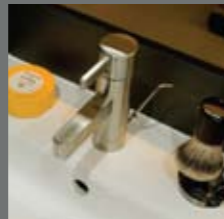

LEICHT

AXOR

LUTRON

SIEMENS

Villeroy&Boch

BANHAM

BAYNHAM  
COULDRIDGE

www.baynhamcouldridge.co.uk



www.brikproperty.co.uk

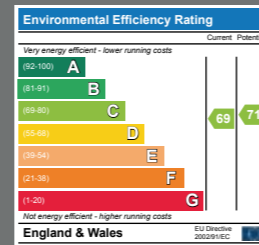
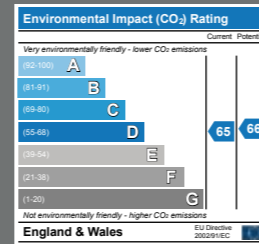

Under the Property Misdescriptions Act these particulars are intended as a guide and act as information only. They do not constitute an offer or part of a contract but give a fair description for the guidance of potential purchasers. All details and approximate measurements are given in good faith and believed to be correct at time of printing. Potential purchasers should not rely on them as statements or representations of fact but must satisfy themselves as to their correctness by inspection or otherwise.

intu design

Brochure by Intu Design  
Tel: 020 7610 0200  
Photography: Chris Wood

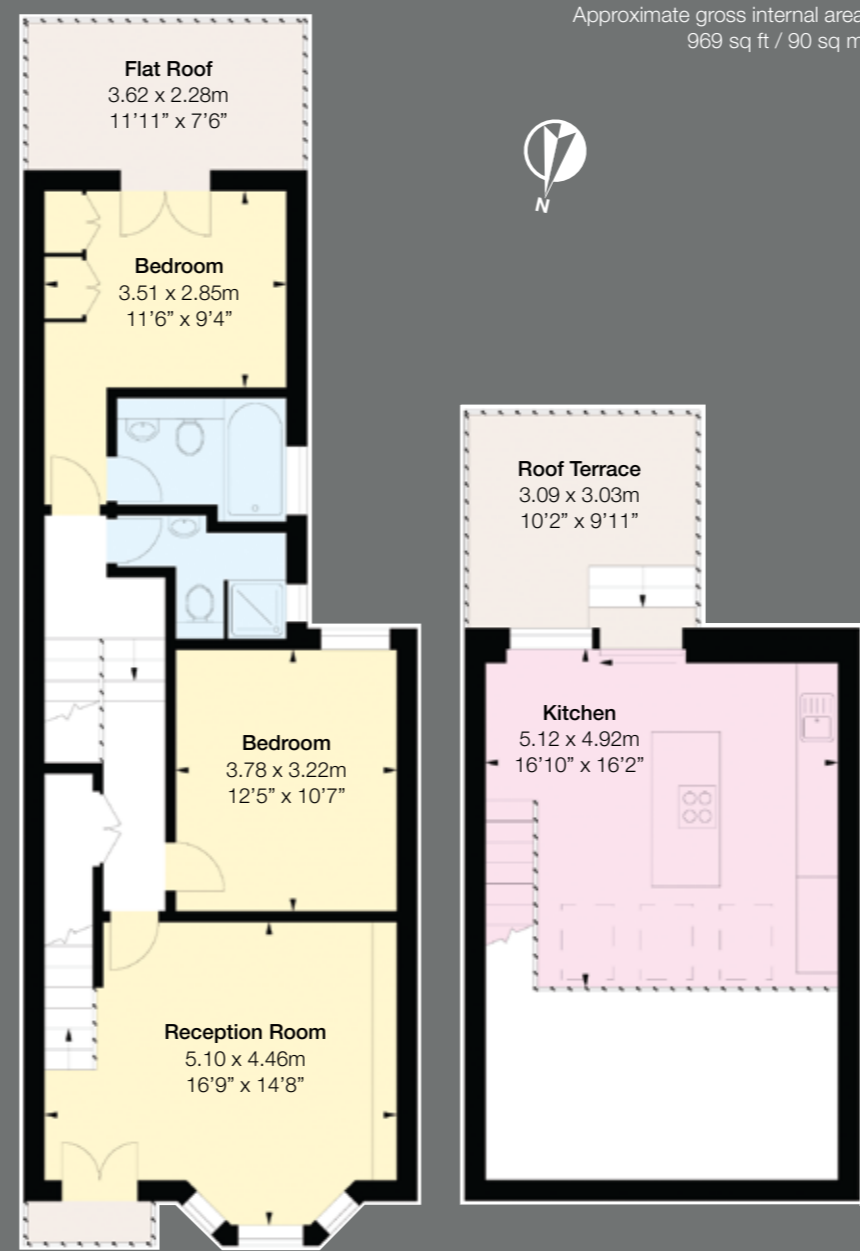

Ground Floor  
Entrance

First Floor

Mezzanine

BAYNHAM  
COULDRIDGE



42a Hestercombe Avenue  
Fulham, SW6